

Type WF

The Webfix allows a quick installation directly from the web of purlins.



Hole Position: Canted Purlins

When purlins are connected to a sloping roof beam, the maximum allowable distance X (hole centre to the bottom edge of the purlin) must decrease.

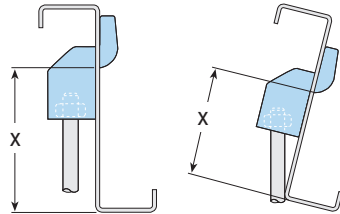

Hole Position: Inclined Purlins

Type WF adjusts to whatever angle is required. Hole position is not a limiting factor on product installation.

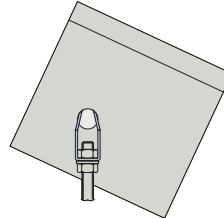

Material: Mild steel, zinc plated.

Code	Rod	Safe Working Load (FOS 5:1) kN	Maximum Purlin Thickness mm	Hole Ø mm	Maximum Distance X at Angle of		
					10° mm	20° mm	30° mm
WF10	M10	1.0	4	18	103	94	74

How to install...

- 1) Squeeze the legs of the Type WF together and push through the hole until it clicks into place.
- 2) Assemble with the nut, ensuring full thread capture.

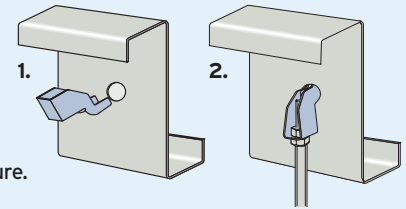

Type HCW30

A purlin clip suitable for horizontal purlins.

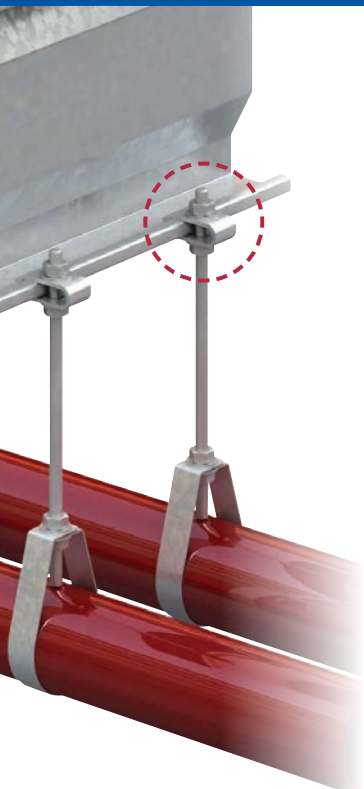

Type HCW30 >



Type HCW31 >



Material: Pre-galvanised strip.

Type HCW31

A universal purlin clip suitable for multiple applications.

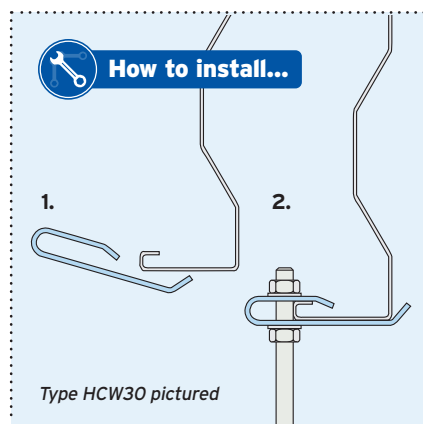

Code	Purlin	Rod	Safe Working Load (FOS 3:1)	
			Tensile kN	Tightening Torque Nm
HCW30	Kingspan Multibeam 3	M10	0.2	8
HCW31	Kingspan Multibeam 3	-	0.2	-

➤ Safe working loads are subject to the strength of the purlin. Please refer to the purlin manufacturer's literature.



GIRDER CLAMPS

RAIL FIXINGS

LIFTING POINTS

HULL-BOLT

FLOOR FIXINGS

SUPPORT FIXINGS

DECKING FIXINGS